

Models

- RT22-4125M-01** 52 channels, 433.92 MHz
- RT22-5025M-01** 52 channels, 868.30 MHz

Scope of Delivery

Multi-channel transmitter incl. batteries
 Programming cable
 Operating instructions

Intended Use

The multi-channel transmitter was developed to operate ELDAT radio controls. The manufacturer does not assume any liability for damage caused as a result of improper or non-intended use!

Safety Advice



Before using the transmitter, carefully read through the operating instructions!

Note also the operating instructions of the radio controls to be operated!

Never operate doors or other items of equipment without keeping them under watch as you do so. Persons could be placed in danger!

Check at regular intervals that the device is ready to transmit!

Do not make any unauthorized alterations or modifications to the transmitter!

Have faulty transmitters checked by the manufacturer!

Function

The RT22 Multi Channel Transmitter has 4 levels (I to IV), each with 13 individually coded radio channels.

So a total of 52 functions can be individually controlled.

The Multi Channel Transmitter is factory coded. You can change the coding of each button individually and of all buttons simultaneously (see section "Code Changing Modes").

Using the Transmitter

Start-Up

The Multi Channel Transmitter is supplied with batteries already inserted so, once unpacked, it is ready for immediate use.

1. Take the Multi Channel Transmitter out of the package.
2. Transfer the codes of the Multi Channel Transmitter to the radio controls (see operating instructions of the radio controls).

Note: channel selection is described in the section entitled "Operation / Transmission".

Operation / Transmission

1. Select the required level using the level buttons. The respective LED lights up for approx. 5 seconds and then goes out. The selected level is activated for 3 minutes.
2. Within the 3 minutes, press one of the channel buttons. The transmitter will transmit for as long as the channel button is pressed, up to a maximum of 36 seconds. During transmission, the LED flashes and then goes out.
3. **Note:** Every time one of the channel buttons is pressed, the selected level is activated for a further 3 minutes. The transmitter then switches automatically to Level I.

Code Changing Modes

Teach-in:

Individual button codes can be taught in from already existing transmitters or the codes of the Multi Channel Transmitter can be transferred to other transmitters.

Duplicate:

The coding of all the buttons can be transferred in their entirety to another Multi Channel Transmitter.

Random coding:

A new random code can be programmed on individual buttons of the Multi Channel Transmitter.

Teach-in procedure

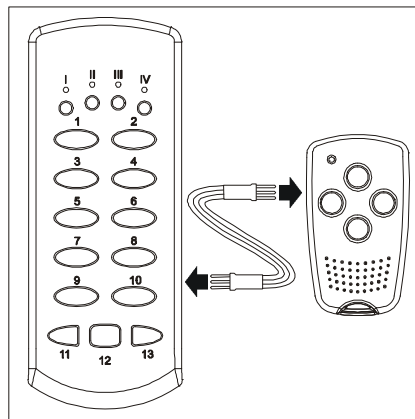

Teaching-In – Hand Transmitter to Multi Channel Transmitter

1. Connect the Hand Transmitter and the Multi Channel Transmitter using the programming cable.
2. Press the required channel button on the Hand Transmitter and hold it down. The LED lights up.
3. Select the required level on the Multi Channel Transmitter using the level buttons.
4. Press the required channel button on the Multi Channel Transmitter and hold it down. The respective LED for that level then flashes quickly. When the LED on the Multi Channel Transmitter is continuously lit, this indicates that the new code has been taught in. Release both buttons.

Teaching-In – Multi Channel Transmitter to Hand Transmitter

1. Connect the Multi Channel Transmitter and Hand Transmitter using the programming cable.
2. Select the required level on the Multi Channel Transmitter using the level buttons.
3. Press the required channel button on the Multi Channel Transmitter and hold it down. The respective LED for that level flashes slowly.
4. Press the required channel button on the Hand Transmitter and hold it down. The LED flashes quickly. When the LED on the Hand Transmitter is continuously lit, this indicates that the new code has been taught in. Release both buttons.

Teaching-In – Multi Channel Transmitter to Multi Channel Transmitter

1. Connect the source and target transmitter using the programming cable.
2. Select the required level using the level buttons on the source transmitter.
3. Press the required channel button on the source transmitter and hold it down. The LED for that level will flash slowly.
4. Select the required level using the level buttons on the target transmitter.
5. Press the required channel button on the target transmitter and hold this down. The LED for that level flashes quickly. When the LED on the target transmitter is continuously lit, this indicates that the new code has been taught in. Release both buttons.

Duplicate

1. Connect both Multi Channel Transmitters using the programming cable.
2. Hold down the level III button on the target transmitter until LED III flashes.
3. Hold down the level IV button on the source transmitter until LED IV flashes.
4. On both the target transmitter and the source transmitter, press channel button 12 and hold down. The LED III on the target transmitter flashes quickly, while the LED IV on the source transmitter flashes slowly. When both LEDs go off, the duplication function is complete. Release both buttons.

Aborting the random coding process

- Press the button 11 or the button 13.

Random Coding

1. Insert the programming cable into the socket on the Multi Channel Transmitter, and at the other end of the cable short-circuit one of the outer pins with the middle pin.

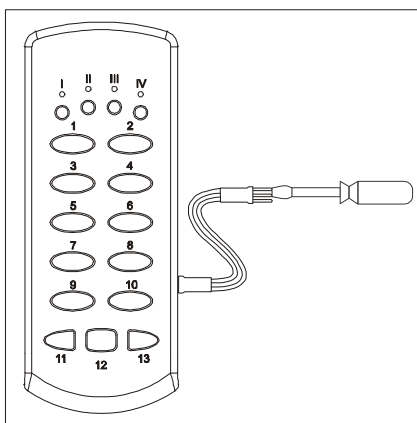

2. Select the required level using the level buttons.
3. Press one of the channel buttons and hold it down. The LED for that level will flash quickly. When the LED is continuously lit, this indicates that a new code has been assigned at random. Release the button.

Note: After the channel button has been released, the selected level remains activated for a further 10 seconds for the re-coding of further channel buttons. The transmitter then automatically switches to Level I.

Caution!

The new coding must be transferred to the radio control.

Replacing Batteries

1. Unscrew the battery housing cover.

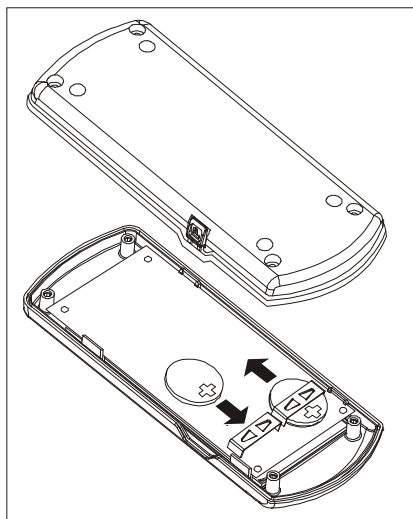

2. Remove the old batteries.
3. Insert two new 3 V batteries. Use only batteries of type CR2032. **Make sure the polarity is correct!**
4. Screw the battery housing cover back on.

Caution!

Keep batteries out of reach of children!

Troubleshooting

- The LEDs are only faint when lit up: Change the batteries.
- The LEDs do not light up at all: Check the polarity of the batteries.
- Move closer to the radio control or teach-in the Multi Channel Transmitter channels to the radio control(s) again.

Cleaning

Wipe the housing carefully with a damp lint-free cloth.

Caution!

Do not use solvent-based cleaning agents. These can damage your health and destroy the surface of the housing.

General Information

Disposal

Waste electrical products and batteries should not be disposed of with household waste!

Dispose of the waste product via a collection point for electronic scrap or via your specialist dealer.

Dispose of used batteries in a recycling bin for batteries or via the specialist trade.

Put the packaging material into the recycling bins for cardboard, paper and plastics.



Warranty

Within the statutory warranty period we undertake to rectify free of charge by repair or replacement any product defects arising from material or production faults.

Any unauthorized tampering with, or modifications to, the product shall render this warranty null and void.

Conformity

This product conforms to the basic requirements of the R&TTE Directive 1999/5/EC.



For use in: EU/CH/FL/N/IS

The Declaration of Conformity can be found on the Internet at: www.eldat.de.

Technical Details

Frequency:	433.92 or 868.30 MHz (depending on model)
Power supply:	2 x 3V batteries, CR2032
Indicator:	LED
Current consumption:	approx. 15 mA
Degree of Protection:	IP 54
Operating temperature:	-20°C to +60°C
Range:	under favourable open field conditions: approx. 100 m in buildings: approx. 30 m
Dimensions:	150 x 60 x 22 mm
Weight:	approx. 100 g

Customer Service

If, despite correct handling, faults or malfunctions occur or if the product was damaged, please contact the company at the address below:

ELDAT GmbH
 Im Gewerbepark 14
 D-15711 Zeesen
 Germany
 Phone: + 49 (0) 33 75 / 90 37-0
 Fax: + 49 (0) 33 75 / 90 37-90
 Internet: www.eldat.de
 e-Mail: info@eldat.de